

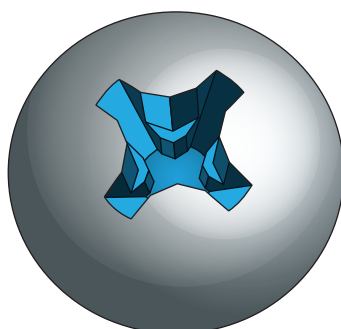

Cross recess that can be turned with both No. 2 and No. 3 bits

# SHARE CROSS



Cross recess for tightening and loosening screws with both No. 2 and No. 3 bits.

# "SHARE CROSS" solves these problems!

## Crushing of the cross recess!

Problem caused by using bits that do not fit the cross recess size.

I thought I could use this bit...

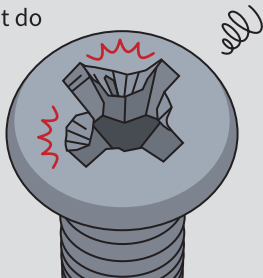

No crushing of the cross recess regardless of whether No.2 or No.3 bits are inserted.

## Replacing bits is time-consuming!

This one is No.2



This one is No.3



Eliminates the need to change bits, regardless of which bit was used in the previous process.

### MECHANISM

The basic shape is a small-sized cross recess with a larger cross recess placed on top.

Sufficient contact area (torque transmission area) is assured for insertion of both bits, thus maintaining good drive recess strength.

Of course, there is absolutely no problem with the mating.

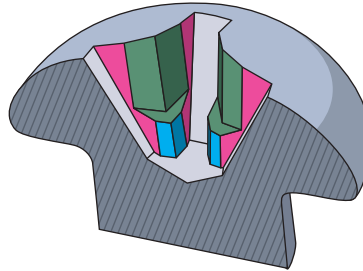

- Contact area for No.2 bit
- Contact area for No.3 bit
- Common contact area for No. 2 and No. 3 bits

### DEMONSTRATE

#### Screw drive recess strength verification test

Test conditions : Wood screw  $\phi 5.8 \times 50$  Zinc trivalent chromate plating

[ No.2 bit ]

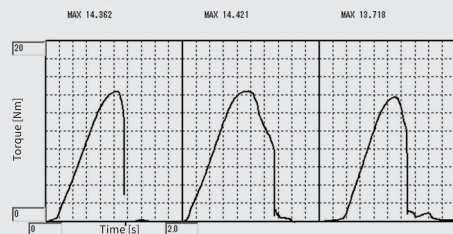

[ No.3 bit ]

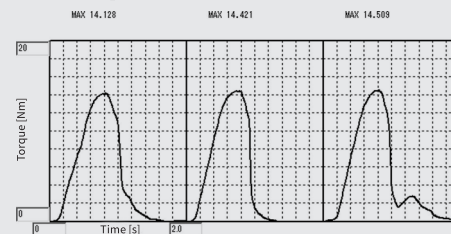

In all cases of both bits, the test was terminated due to "male screw head breakage".

**Both drive recesses were not crushed and were fully robust.**



For common drive recess sizes, No. 2 and No. 3 are the basic specifications, but other applications are also available upon request.

# NITTOSEIKO CO.,LTD.

Fastener Division Global Sales Section

1-6-4, Honjyo-nishi, Higashiosaka city, Osaka, 578-0965, Japan

Tel +81-6-6745-8392 Fax +81-6-6745-8372

E-mail : sales@nittoseiko.co.jp

URL : <https://www.nittoseiko.co.jp/en.html>



Specifications are subject to change without notice for performance improvement.  
SHARE CROSS is trademark for NITTOSEIKO CO., LTD.