

1. Outline

CLEAN FLOW is a mass flow meter which realize high performance and high reliability. It can measure mass flow directly by detecting phase difference of measuring tube which is generated by Coriolis.

High-functionality transmitter has capacitance touch panel which makes setting and operation easy. And 3 lines LCD indication can be set various kind of indication article.

2. Feature

- It can measure mass flow directly, it is not affected temperature, pressure, viscosity, density, or flow distribution due to its measurement principle.
- Compact design
- It does not need special fixture. Easy installation.
- New type measuring tube realizes low pressure loss.
- Various indication article by 3 line LCD.
- Good visibility by Buck-light display.
- Plug-in card can add out/input easily. (Option)



3. General specification

● Sensor

Size	015	025	050	080	100	150
Nominal diameter	10A, 15A, 20A, 25A, 40A, 50A, 65A, 80A, 100A, 150A, 200A					
Connection end	JIS10K, 20K ASME/ANSI 150, 300, 600 JPI 150, 300, 600 DIN PN16, 40, 63 Tri-clamp					
Fluid	Liquid/Gas					
Flow range	0 ~ 860,000 Kg/h (6 type)					
Accuracy	Volume	Liquid	General:	Mass flow	±0.4%	
				Volume flow	±0.4%	
		Gas	High accuracy:	Mass flow	±0.15% (±0.1%option)	
				Volume flow	±0.15%	
Density	Liquid	General:	0.010kg/L			
		High accuracy:	0.002kg/L (0.001kg/L option)			
Temperature	General:		-50 ~ 160 °C		(T1,T3:-40~120°C)	
	High accuracy:		-50 ~ 205 °C		(J1:-40~140°C)	
	Explosion-proof type is depending on the specification					
Pressure	Depending on the connection end					
Wetted parts material	Stainless steel (Standard), Alloy C (Option)					
Explosion-proof	ATEX / IECEx, cFMus, CML					

● Transmitter

Power	100 ~ 240V AC, 50/60Hz 11 ~ 30V DC
Power consumption	20W
Protection level	Unit type : IP65 / IP67, NEMA 4X Remote type: IP65 / IP67 / IP68 (Sensor only, Immersion depth 5m), NEMA 4X
Housing material	Aluminum Stainless (Remote type: Option)
Output signal	Analog: 4-20mA DC (Active mode or Passive mode) Digital: 2 points (Pulse or switch) (Passive mode) HART (Protocol Ver. 7.1)
Dumping	0.8 sec. (Available setting 0.2 ~ 100 sec)
Low cut-off	1% of Max. flow rate. (Available setting 0~5%)
Transmission distance	Max. 200m (Remote type)

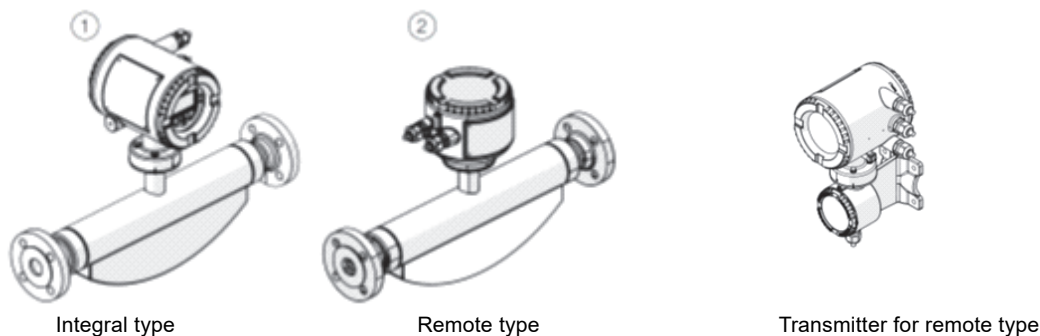

4. Flow range, Accuracy

●Liquid measurement

Size	015	025	050	080	100	150	
Flow range	MASS flow[kg/h]	0~8,000	0~35,000	0~90,000	0~250,000	0~520,000	0~860,000
	Volume flow [L/h] (※1)	0~8,000	0~35,000	0~90,000	0~250,000	0~520,000	0~860,000
(※1) Volume flow is according to the 1g/mL of density. In case of other than 1mg/mL Volume flow = Mass flow / Density.							
Zero-stability [kg/h]	0.64	2.16	7.2	20	41.6	68.8	

●Basic accuracy

Model	430 (General type)	450 (High accuracy type)
Mass flow (Liquid)	±0.4%	±0.15%
	±0.25% (Option)	±0.10% (Option)
	±0.20% (Option)	
Mass flow (Gas)	±1.0%	±0.5%
Volume flow	±0.4%	±0.15%
	±0.25% (Option)	
	±0.20% (Option)	
Repeatability (volume)	Refer to below table	
Density (Liquid)	0.010kg/L	0.002kg/L
		0.001kg/L
Repeatability (density)	0.002kg/L	0.002kg/L
		0.001kg/L

●Measuring accuracy

		Max. measuring accuracy	Repeatability
1	Flow rate $\geq \frac{\text{Zero-stability}}{(\text{General accuracy}/100)}$	±General accuracy	±1/2×General accuracy
2	Flow rate < $\frac{\text{Zero-stability}}{(\text{General accuracy}/100)}$	± (Zero-stability/Measured value) ×100%	±1/2× (Zero-stability/Measured value) ×100%

5. Pressure loss

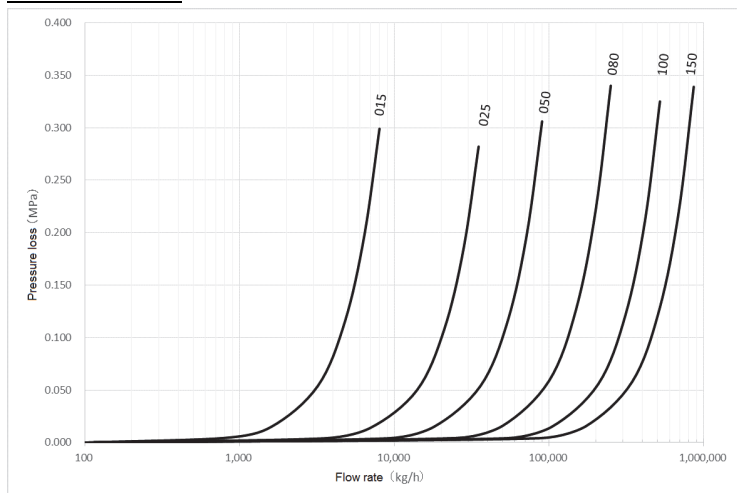

Pressure loss (result by water @ 20°C /1mPa.s)
Please inquiry in case of other viscosity.

6. External dimensions

● Integral type

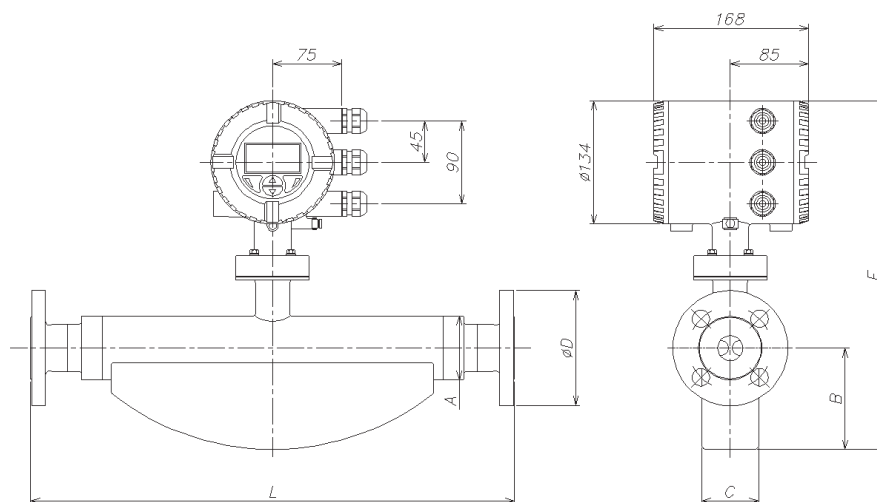

Meter size	Size (mm)				Approx. weight (kg)
	A	B	C	E	
0 1 5	φ 4 4 . 5	7 7	4 6	3 4 0	9
0 2 5	φ 6 9 . 5	1 0 3	6 2	3 7 9	1 1
0 5 0	φ 9 9	1 2 5	8 0	4 1 6	2 7
0 8 0	φ 1 5 5	1 8 3	1 2 3	5 0 5	7 1
1 0 0	φ 1 8 5	2 6 1	1 6 8	6 0 3	1 2 3
1 5 0	□ 2 6 0	3 2 0	2 0 5	6 9 1	1 8 1

Note) Approximate weight may be changed as per connection end and material.

External dimensions are changed as per meter size.

● Remote type

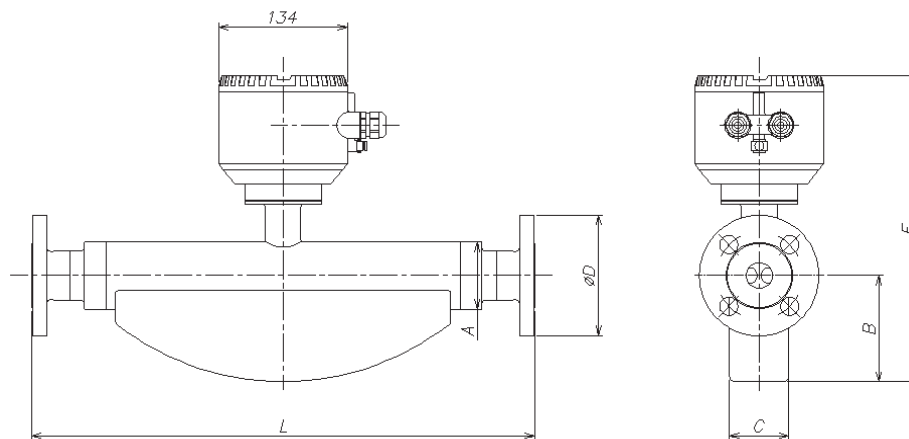

Meter size	Size (mm)				Approx. weight (kg)
	A	B	C	E	
0 1 5	φ 4 4 . 5	7 7	4 6	3 4 0	9
0 2 5	φ 6 9 . 5	1 0 3	6 2	3 7 9	1 1
0 5 0	φ 9 9	1 2 5	8 0	4 1 6	2 7
0 8 0	φ 1 5 5	1 8 3	1 2 3	5 0 5	7 1
1 0 0	φ 1 8 5	2 6 1	1 6 8	6 0 3	1 2 3
1 5 0	□ 2 6 0	3 2 0	2 0 5	6 9 1	1 8 1

Note) Approximate weight may be changed as per connection end and material.

External dimensions are changed as per meter size.

●015 sensor connection standard

Connection end	Specification code	L (mm)	D (mm)
15A JIS20K	015R0J2	385	95
1/2" CL150 (ASME B 16.5)	015R0A1	435	89
1/2" CL300 (ASME B 16.5)	015R0A3	421	95
20A JIS20K	015R1J2	421	100
3/4" CL150 (ASME B 16.5)	015R1A1	421	98
Conform to DIN 32676 1/2" Tri-clamp	015R0T1	413	34
Conform to ASME BPE 1/2" Tri-clamp	015R0T3	433	25

●025 sensor connection standard

Connection end	Specification code	L (mm)	D (mm)
20A JIS20K	025E1J2	576	100
3/4" CL150 (ASME B 16.5)	025E1A1	575	98
25A JIS20K	025R0J2	525	125
1" CL150 (ASME B 16.5)	025R0A1	575	108
1" CL300 (ASME B 16.5)	025R0A3	576	124
40A JIS20K	025R2J2	576	140
1-1/2" CL150 (ASME B 16.5)	025R2A1	576	127
In accordance with DIN 32676 1" Tri-clamp	025R0T1	590	50.5
In accordance with ASME BPE 1" Tri-clamp	025R0T3	590	50.4

●050 sensor connection standard

Connection end	Specification code	L (mm)	D (mm)
40A JIS20K	050E1J2	763	140
1-1/2" CL150 (ASME B 16.5)	050E1A1	763	127
1-1/2" CL300 (ASME B 16.5)	050E1A3	756	156
50A JIS10K	050R0J1	715	155
2" CL150 (ASME B 16.5)	050R0A1	715	152
2" CL300 (ASME B 16.5)	050R0A3	763	165
65A JIS10K	050R1J1	763	175
2-1/2" CL150 (ASME B 16.5)	050R1A1	756	178
In accordance with DIN 32676 2" Tri-clamp	050R0T1	740	64
In accordance with ASME BPE 2" Tri-clamp	050R0T3	740	63.9

●080 sensor connection standard

Connection end	Specification code	L (mm)	D (mm)
65A JIS10K	080E1J1	910	175
2-1/2" CL300 (ASME B 16.5)	080E1A3	920	178
80A JIS10K	080R0J1	870	185
3" CL150 (ASME B 16.5)	080R0A1	880	191
3" CL300 (ASME B 16.5)	080R0A3	895	210
100A JIS10K	080R1J1	1060	210
4" CL150 (ASME B 16.5)	080R1A1	880	229
In accordance with DIN 32676 3" Tri-clamp	080R0T1	910	106
In accordance with ASME BPE 3" Tri-clamp	080R0T3	910	90.9

●100 sensor connection standard

Connection end	Specification code	L (mm)	D (mm)
80A JIS10K	100E1J1	1275	185
3" CL300 (ASME B 16.5)	100E1A3	1244	210
100A JIS10K	100R0J1	1150	210
4" CL150 (ASME B 16.5)	100R0A1	1144	229
4" CL300 (ASME B 16.5)	100R0A3	1324	254
150A JIS10K	100R2J1	1300	280
6" CL150 (ASME B 16.5)	100R2A1	1330	279

Note) This size is for major item. Unavailable for manufacturing depend on the combination.

● 150 sensor connection standard

Connection end	Specification code	L (mm)	D (mm)
4" PN16 (EN 1092-1)	150E2D2	1569	220
6" PN16 (EN 1092-1)	150R0D2	1421	285
6" CL150 (ASME B 16.5)	150R0A1	1485	279
6" CL300 (ASME B 16.5)	150R0A3	1505	318
8" CL150 (ASME B 16.5)	150R2A1	1650	343
8" CL300 (ASME B 16.5)	150R2A3	1670	381

Note) This size is for major item. Unavailable for manufacturing depend on the combination.

● Transmitter for remote type (Type FT)

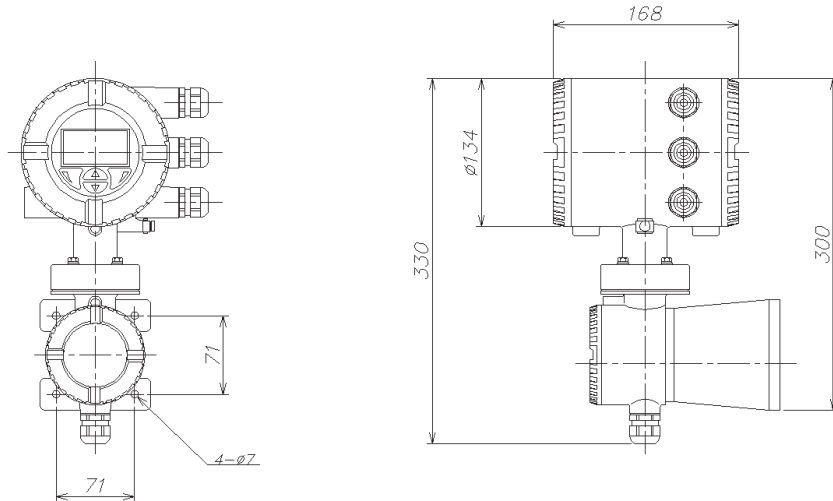

Weight: 4.5Kg.

7. Transmitter

● Indication contents

Mass flow, Volume flow, Density, Temperature, and any others (Available for select).

4 kind of monitor for operator can be set, and it can indicate several measuring result simultaneously.

Indicator has 3 line LCD, and variety of indication is available.

● Operation

Operated by capacitance touch panel through the glass is available.

Set according to the menu by 4 operation keys.

● Standard output

Analog output: 1 point (4~20mADC/HART7)



Digital output: 2 points (Pulse, frequency)

● Optional plug-in cards (for additional output)

The transmitter has two slots in which plug-in cards can be inserted to provide additional inputs and outputs.

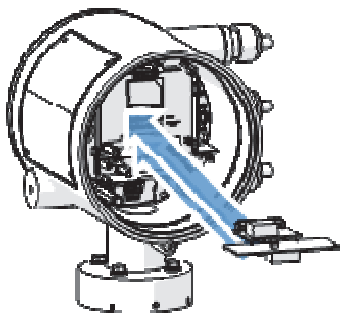
The slots are located on the transmitter motherboard and can be accessed after removing the front housing cover.

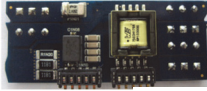

Plug-in card	Description	Number ¹⁾
	Passive current output, 4~20 mA (red)	Two cards
	Passive digital output (green)	One card
	Passive digital input (yellow)	One card
	24 V DC power supply (blue)	One card

1) The "Number" column indicates the maximum number of plug-in cards of the same type that can be used.

Note: Please refer to next page for the possible combination of plug-in cards

● The possible combination of plug-in cards

Output code	Additional output code		Slot OC1 Terminals V1 / V2	Slot OC2 Terminals V3 / V4
	Output 1	Output 2		
G0	—	—	—	—
G1	x	—	24 V DC power supply (blue)	—
G2	—	x	—	Passive current output, 4~20 mA (red)
G3	x	x	Passive current output, 4~20 mA (red)	Passive current output, 4~20 mA (red)
G0	DRT	DSN	24 V DC power supply (blue)	Passive digital input (yellow)
G0	DRT	DSG	24 V DC power supply (blue)	Passive digital output (green)
G0	DRT	DSA	24 V DC power supply (blue)	Passive current output, 4~20 mA (red)
G0	DRN	—	Passive digital input (yellow)	—
G0	DRN	DSG	Passive digital input (yellow)	Passive digital output (green)
G0	DRN	DSA	Passive digital input (yellow)	Passive current output, 4~20 mA (red)
G0	DRG	DSN	Passive digital output (green)	Passive digital input (yellow)
G0	DRG	DSA	Passive digital output (green)	Passive current output, 4~20 mA (red)

● Terminal block

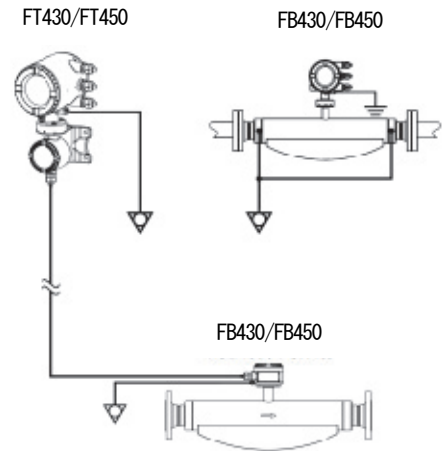
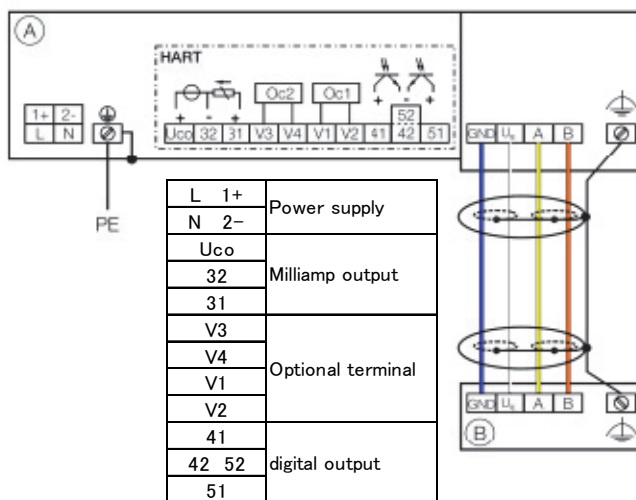

● IP rating

In accordance with EN 60529 : IP65/IP67, NEMA4X

● Vibration

In accordance with EN 60068-2

10~58Hz, Max deflection 0.15mm (Peak load)

58~150Hz, Max. acceleration 2G (Peak load)

● Ambient temperature

Standard : -20~70°C Option : -40~70°C

Note) When operating below -20°C, visibility of the LCD display may be worse.

● Signal cable (Remote type: between sensor and transmitter)

Impedance 100~200Ω

Withstand voltage 120V

Outer diameter 6~12mm

Cable design 4 core shielded cable (2 wire pairs as a star-quad cable)

Max. signal cable length

0.25mm² : 50m

0.34mm² : 100m

0.50mm² : 150m

0.75mm² : 200m

● Power

AC Power Terminal	:	L/N
Operating voltage	:	100~240VAC 50/60Hz
Power consumption	:	20VA
DC Power Terminal	:	1+ / 2-
Operating voltage	:	11~30VDC
Power consumption	:	20W

● Output

Standard output

Current output

Current output	Active mode	Passive mode
Terminal	Uco(+)/32(-)	31(+)/32(-)
Output signal	4~20mADC or 4~12~20mADC Switchable	4~20mADC
Load resistance	250~300Ω	250~600Ω
Source voltage	—	12~30V
Measuring error	0.1% or less of measured value	

Digital output

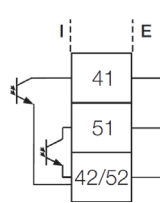
Digital output	Pulse/frequency output (passive)	Binary output (passive)	
Terminal	41(+)/42(-), 51(+)/52(-)	41(+)/42(-), 51(+)/52(-)	
Output "closed"	Voltage 3VDC or less 2.5kHz or less : 2~30mA More than 2.5kHz : 10~30mA	Voltage 3VDC or less 2~30mA	
Output "open"	Voltage 16~30VDC 0.2mA or less	Voltage 16~30VDC 0.2mA or less	
Max. frequency	10.5kHz	—	
Pulse width	0.1~2,000ms	—	

Option output

Option (by plug-in card)

• Passive current output (red)

Terminal	V1(+)/V2(-), V3(+)/V4(-)	The plug-in card can be used in slot OC1 or OC2
Output signal	4~20mA	
Load resistance	250~600Ω	
Source voltage	12~30VDC	
Measuring error	0.1% or less of measured value	

• Digital output (green): Binary output (Passive)

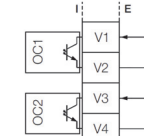
Terminal	V1/V2, V3/V4	The plug-in card can be used in slot OC1 or OC2	
Output "closed"	Voltage 3VDC or less 2~30mA		
Output "open"	Voltage 16~30VDC 0.2mA or less		

• Digital input (Yellow)

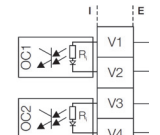
Terminal	V1(+)/V2(-), V3(+)/V4(-)	The plug-in card can be used in slot OC1 or OC2	
Input "ON"	Voltage 16V~30VDC		
Input "OFF"	Voltage 3VDC or less		
Internal resistance	6.5kΩ		

• 24VDC Power supply (blue)

Terminal	V1(+)/V2(-)	The plug-in card can be used in slot OC1 only.
Function	For active connection of passive outputs	
Output voltage	24VDC at 0mA 17VDC at 25mA	
Load rating	25mA, permanently short circuit-proof	

8. Specification code

Unit type/ Remote type sensor

Article		Specification code		Note
Model	FB450			Coliolis Mass flow meter / High accuracy type
	FB430			Coliolis Mass flow meter / General type
Explosion Protection Certificate	Y0			General Purpose
	T1			CML
	A1			ATEX/IECEX (Zone 1/21)
	F1			cFmus version Class 1 Div. 1 (Zone 1/21)
Transmitter type / Material / Cable Gland	Y0			When select "Unit type"
	U1			Remote type / Aluminum / 1-M20×1.5
	U2			Remote type / Aluminum / 1-NPT1/2
	A1			Remote type / Stainless / 1-M20×1.5
	A2			Remote type / Stainless / 1-NPT1/2
Meter size / Connection size	015E1			015/10A (3/8B)
	015R0			015/15A (1/2B) : Standard
	015R1			015/20A (3/4B)
	025E1			025/20A (3/4B)
	025R0			025/25A (1B) : Standard
	025R2			025/40A (1-1/2B)
	050E1			050/40A (1-1/2B)
	050R0			050/50A (1B) : Standard
	050R1			050/65A (2-1/2B)
	080E1			080/65A (2-1/2B)
	080R0			080/80A (3B) : Standard
	080R1			080/100A (4B)
	100E1			100/80A (3B)
	100R0			100/100A (4B) : Standard
	100R2			100/150A (6B)
	150E2			150/100A (4B)
	150R0			150/150A (6B) : Standard
150R2			150/200A (8B)	
Process Connection Type	J1			Flange JIS 10K
	J2			Flange JIS 20K (40A or less standard)
	D2			Flange DIN PN16
	D4			Flange DIN PN40
	D5			Flange DIN PN63
	D6			Flange DIN PN100
	A1			Flange ANSI/ASME B16.5 Class 150
	A3			Flange ANSI/ASME B16.5 Class 300
	A6			Flange ANSI/ASME B16.5 Class 600
	A7			Flange ANSI/ASME B16.5 Class 900
	A8			Flange ANSI/ASME B16.5 Class 1500
	T1			In accordance with DIN 32676 Tri-clamp
T3			In accordance with ASME BPE Tri-clamp	
F1			In accordance with DIN 11851 Fitting	
Material of Wetted Parts	A1			Stainless steel
	C1			Ni-Alloy (Alloy-C)
Flow Calibration	A			Flow forward : Liquid±0.4 % , Gas : ±1.0 %General type
	B			Flow forward : Liquid±0.25 % , Gas : ±1.0 %General type
	E			Flow forward : Liquid±0.2 % , Gas : ±1.0 %General type
	C			Flow forward : Liquid±0.15 % , Gas : ±0.5 %High accuracy type
	D			Flow forward : Liquid±0.1 % , Gas : ±0.5 %High accuracy type
	J			Flow forward/reverse : Liquid±0.4 % , Gas : ±1.0 %General type
	K			Flow forward/reverse : Liquid±0.25 % , Gas : ±1.0 %General type
	N			Flow forward/reverse : Liquid±0.2 % , Gas : ±1.0 %General type
Density Calibration	L			Flow forward/reverse : Liquid±0.15 % , Gas : ±0.5 %High accuracy type
	M			Flow forward/reverse : Liquid±0.1 % , Gas : ±0.5 %High accuracy type
	1			Density 10 g/LGeneral type
	3			Density 2 g/LHigh accuracy type
Transmitter Type / Material / Cable gland	4			Density 1 g/LHigh accuracy type
	9			Others
	D1			Unit type / Aluminum / 3-M20×1.5
	D2			Unit type / Aluminum / 3-NPT1/2
	D5			Unit type / Aluminum / 3-NPT1/2 (Explosion protection)
Output ※1	D6			Unit type / Aluminum / 3-M20×1.5 (Explosion protection)
	Y0			When select "Remote type"
	G0			Current output 1 (AorP) , Digital output 1&2 (P) , HART
	G1			Current output 1 (AorP) , Digital output 1&2 (P) , 24VDC loop supply, HART
	G2			Current output 1 (A) , Digital output 1&2 (P) , current output 2 (P) , HART
Power supply	G3			Current output 1 (A) , Digital output 1&2 (P) , current output 2&3 (P) , HART
	Y0			Without: when select remote type
	A			100~230VAC
	C			11~30VDC
	Y			Without: when select remote type

※1 A: Active mode
P: Passive mode

Sensor option

Article	Additional specification code		Note
Additional output 1 ※1	DRN		1×Digital input
	DRG		1×Digital output
	DRA		1×Analog output(P) (4~20mA)
	DRT		24VDC transmitter loop power supply
	DRM		MODBUS communication
Additional output 2	DSN		1×Digital input
	DSG		1×Digital output
	DSA		1×Analog output(P) (4~20mA)
Special operation mode	N6		Standard + DensiMass : concentration measurement :only 450 type
	N5		Standard + Filling application
	N7		VeriMass function: Meter verification : only 450 type
Pressure-resistance Sensor Housing	PR5		Max. burst pressure 6MPa (Include tower length extension)
	PR6		Max. burst pressure 10MPa(Include tower length extension): Meter size 015
	PR7		Max. burst pressure 15MPa(Include tower length extension): Meter size 015
Signal Cable Length	SC0		Without
	SC1		5m
	SC2		10m
	SC4		20m
	SC5		25m
	SC6		30m
	SC8		40m
	SCA		50m
	SCE		100m
	SCG		150m
SCJ		200m	
TAG No. Plate	T1		With TAG No. Plate
Ambient Temperature Range	TA9		-40~70°C
Extend Tower Length	TE1		Tower length extension 1, Meter insukation Single
	TE2		Tower length extension 2, Meter insukation Double

※1 P: Passive mode

Remote type (Transmitter)

Article	Specification code		Note
Model	FT450		Coliolis Mass flow meter High accuracy type
	FT430		Coliolis Mass flow meter General type
Explosion Protection Certificate	Y0		General Purpose
	A2		ATEX/IECEX (Zone 2/22)
	A1		ATEX/IECEX (Zone 1/21)
	F2		cFMus version Class 1 Div 2 (Zone 2/21)
	F1		cFMus version Class 1 Div 1 (Zone 1/21)
Transmitter type / Material / Cable Gland	R1		Remote type / Aluminum / 1-M20×1.5
	R2		Remote type / Aluminum / 1-NPT1/2
	R5		Remote type / Staineless / 1-M20×1.5
	R6		Remote type / Staineless / 1-NPT1/2
Output ※1	G0		Current output 1 (AorP), Digital output 1&2 (P), HART
	G1		Current output 1 (AorP), Digital output 1&2 (P), 24VDC loop power, HART
	G2		Current output 1 (A), Digital output 1&2 (P), Current output 2 (P), HART
	G3		Current output 1 (A), Digital output 1&2 (P), Current output 2&3 (P), HART
Power supplu	A		100~230VAC
	C		11~30VDC

Option

Mounting Bracket Shape/ Material	B1		2B Pipe mounting / Carbon steel
Additional output 1	DRN		1×Digital input
	DRG		1×Digital output
	DRA		1×Analog output(P) (4~20mA)
	DRT		24VDC transmitter loop power supply
	DRM		MODBUS communication
Additional output 2	DSN		1×Digital input
	DSG		1×Digital output
	DSA		1×Analog output(P) (4~20mA)
TAG No. Plate	T1		With TAG No. Plate

※1 A: Active mode
P: Passive mode

9. Explosion-proof

(1) CML

●Integral type

- Type : Ex d e ia mb [ia Ga] II C T4 Gb
- ambient temperature : -20°C~+60°C
- fluid temperature : -40°C~+130°C

●Remote type

Sensor

- Type : Ex e ia mb II B+H2 T4 Ga/Gb
- Ambient temperature : -20°C~+60°C
- fluid temperature : -40°C~+130°C

Transmitter

- Type : Ex d e ia mb [ia Ga] II C T6 Gb
- ambient temperature : -20°C~+60°C

●Wiring Port

- Cable gland :
 Conduit screw size : G1/2
 Cable finished outer diameter (mm) : $\phi 6 \sim \phi 12$
 Note) Packing has a various model.
 Please specify the cable outer diameter.

Model No. of Cable gland	Model No. of packing	Cable finished outer diameter (mm)
GEUL10-M-	P6	$\phi 6 \sim \phi 7$
	P5	$\phi 7 \sim \phi 8$
	P4	$\phi 8 \sim \phi 9$
	P3	$\phi 9 \sim \phi 10$
	P2	$\phi 10 \sim \phi 11$
	P1	$\phi 11 \sim \phi 12$

Blind plug is needed for no-use port. Please specify the necessary number of blind plug.

(2) ATEX, IECEx

●Integral type

- Type : II 1/2 (1) G Ex d e ia mb [ia Gb] II C T6...T1 Gb
- Ambient temperature : -40°C~+70°C

ambient temperature	$\leq 30^\circ\text{C}$	$\leq 40^\circ\text{C}$	$\leq 50^\circ\text{C}$	$\leq 60^\circ\text{C}$	$\leq 70^\circ\text{C}$
Class	Max. fluid temperature				
T1	205°C	205°C	205°C	205°C	205°C
T2	205°C	205°C	205°C	205°C	205°C
T3	195°C	195°C	195°C	195°C	195°C
T4	130°C	130°C	130°C	130°C	130°C
T5	95°C	95°C	95°C	95°C	95°C
T6	80°C	80°C	80°C	80°C	80°C

●Remote type

Sensor

- Type : II 1/2 G Ex e ia mb II B+H2 T6...T1 Ga/Gb
- Ambient temperature : -40°C~+70°C

Transmitter

- Type : II 2 (1) G Ex d e ia mb [ia Gb] II C T6...T1 Gb
- Ambient temperature : -40°C~+70°C

ambient temperature	$\leq 30^\circ\text{C}$	$\leq 40^\circ\text{C}$	$\leq 50^\circ\text{C}$	$\leq 60^\circ\text{C}$	$\leq 70^\circ\text{C}$
Class	Max. fluid temperature				
T1	205°C	205°C	205°C	205°C	205°C
T2	205°C	205°C	205°C	205°C	205°C
T3	195°C	195°C	195°C	195°C	195°C
T4	130°C	130°C	130°C	130°C	130°C
T5	95°C	95°C	95°C	95°C	95°C
T6	80°C	80°C	80°C	80°C	—

(3) cFMus

●Integral type

- Type :
 XP-IS: CL1, Div 1, GPS ABCD, T6...T1(USA) XP-IS: CL1, Div 1, GPS BCD, T6...T1 (CAN)
 DIP: CL II, III, GPS EFG, T6 ZN21, AEx ia tb III C T80°C
 CL1, ZN1, AEx d ia II C T6...T1 ZN21, Ex ia tb III C T80°C
 CL1, ZN1, Ex d ia II B+H2 T6...T1
- Ambient temperature : -40°C~+70°C

●Remote type

Sensor

- Type :
 XP-IS: CL1, Div 1, GPS BCD, T6...T1 DIP: CL1 II, III, Div 1, GPS EFG, T6
 CL1, ZN1, AEx d ia II B+H2 T6...T1 ZN21, AEx ia tb III C T80°C
 CL1, ZN1, Ex d ia II B+H2 T6...T1 ZN21, Ex ia tb III C T80°C
- Ambient temperature : -40°C~+70°C

Transmitter

- Type :
 XP-IS: CL1, Div 1, GPS BCD, T6...T1(USA) XP-IS: CL1, Div 1, GPS BCD, T6...T1 (CAN)
 DIP: CL II, III, GPS EFG, T6 ZN21, AEx ia tb III C T80°C
 CL1, ZN1, AEx d ia II B+H2 T6...T1 ZN21, Ex ia tb III C T80°C
 CL1, ZN1, Ex d ia II B+H2 T6...T1
- Ambient temperature : -40°C~+70°C

▼The contents given here are subject to change without notice.

NITTOSEIKO CO.,LTD.



Control System Division Global Sales Section . **【Website】** **【Inquiry Form】**
Website: <https://global.nittoseiko.com/> .